

## Optima® ETF-600/ETF-610



ETF-610



ETF-600

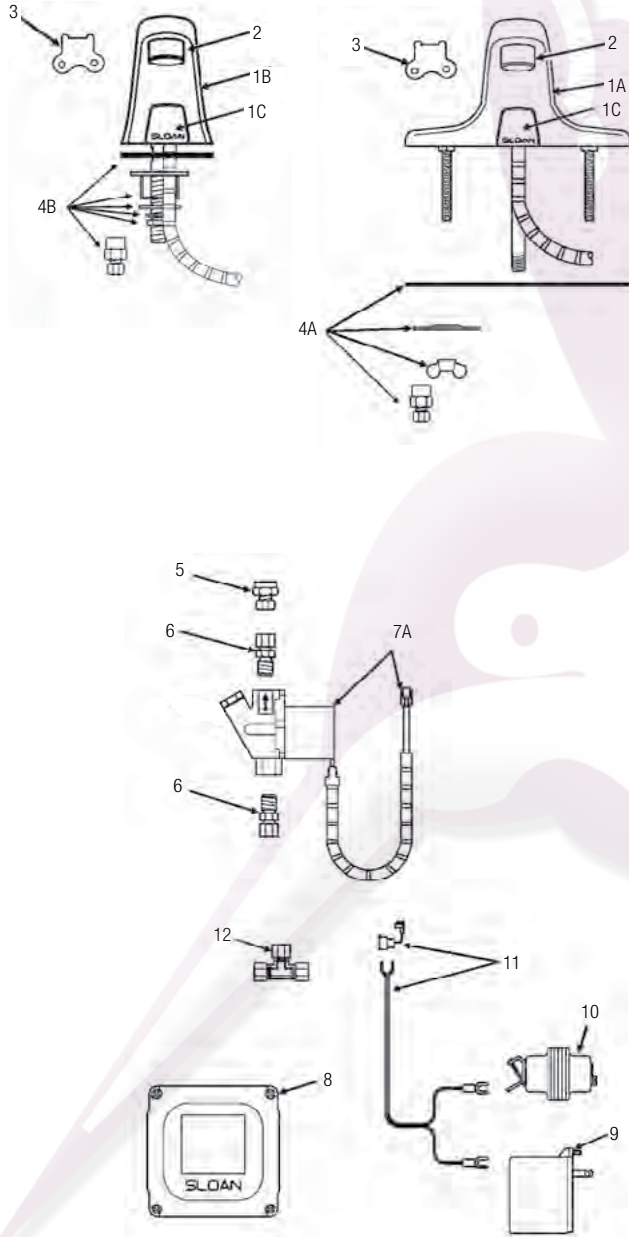

### PARTS LIST—ETF-600 AND ETF-610 FAUCETS

Item No.	Code No.	Part No.	Description
1A.	<b>0365086</b>	ETF-543-A	Faucet and Sensor Assembly (ETF-600)
1B.	<b>0365117</b>	ETF-570-A	Pedestal Faucet and Sensor Assembly (ETF-610)
1C.	<b>0365070</b>	ETF-542-A	Sensor Module <b>Only</b> (for ETF-600 and ETF-610 faucets) includes 18" (153 mm) armored Cable, Shroud, and Housing for Sensor Window
2.	<b>3365092</b>	ETF-1023-A	0.5 gpm (1.9 Lpm) Spray Head with Key (male thread)
	<b>3365093</b>	ETF-1024-A	2.2 gpm (8.3 Lpm) Aerator Spray Head with Key (male thread)
	<b>3365162</b>	ETF-1029-A	2.2 gpm (8.3 Lpm) Laminar Flow Spray Head with Key (male thread)
	<b>3365756</b>	ETF-1039-A	0.35 gpm (1.3 Lpm) Multi-Lam Spray Head VR
3.	<b>0305927</b>	ETF-435	Replacement Key Only
4A.	<b>3365088</b>	ETF-546-A	Faucet Mounting Kit for ETF-600 includes Base Gasket, two (2) Slotted Mounting Washers, two (2) Wing Nuts, and Compression Fitting Connector
4B.	<b>0315085</b>	EBF-123-A	Faucet Mounting Kit for ETF-610 includes Spacer, Base Gasket, 1/4" NPSM Hex Nut, Washer, 9/16" Lock Washer and Compression Fitting Connector
5.	<b>0365058</b>	ETF-547	1/8" NPT Pipe to 3/8" Tube Compression Fitting Connector (female)
6.	<b>3365676</b>	ETF-437-A	Single Solenoid Supply Kit includes, two (2) Compression Fittings, Compression Nut, and Ferrule
7A.	<b>0305849</b>	ETF-370-A	24 VAC Solenoid Valve Assembly includes 18" (457 mm) armored Cable and two (2) Terminal Housings
7B.	<b>3305577</b>	ETF-1009-A	Solenoid Valve Repair Kit includes Replacement Filter, Guide, Armature Spring, Diaphragm and Washer
7C.	<b>3375003</b>	MCR-1003-A	Diaphragm only
8.	<b>3365000</b>	ETF-450-A	Control Module Assembly includes splashproof Junction Box and Junction Box Mounting Kit
9.	<b>0365534</b>	ETF-233	120V/35VA Plug-In Transformer
10.	<b>0345370</b>	EL-248-40	24V/40VA Box Mount Transformer
11.	<b>0365001</b>	ETF-458-A	Input Power Cable (Transformer to Control Module) includes Strain Relief and two (2) Terminal Crimp Connectors
12.	<b>3365461</b>	ETF-617-A	Bak-Chek® "T" Assembly

See page 157 for faucet cable extension cords.

— = Not shown in illustration

