

## Mezcladora de Fregadero / Sink Mixer

HM-37

NB

## Mezcladora Albatros de Cocina / Albatros Kitchen Mixer

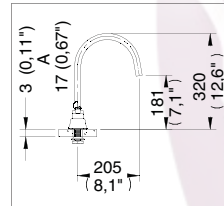
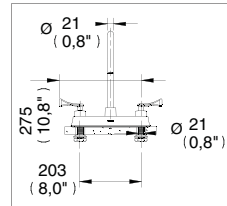

Medidas Referenciales / Estimated Dimensions, Acol.mm.(pulg) / Dim.mm.(in)

### Características y Datos Técnicos / Characteristics and Technical Details

Val-Vex II Izq. y Der. a 1/4" de Vuelta de Discos Cerámicos  
Incluye Herramienta para Sujeción  
Salida Giratoria

**Material:**  
Latón

**Conexión:**  
1/2" - 14 NPSM

**Presión de Trabajo:**  
Pmin= 0,2 kg/cm<sup>2</sup> (2,85 PSI)  
Pmax= 6,0 kg/cm<sup>2</sup> (85,34 PSI)

Val-Vex II Left and Right 1/4" Return Ceramic Discs  
Includes Setting Kit  
Outlet Rotatory

**Material:**  
Brass

**Inlet Thread:**  
1/2" - 14 NPSM

**Working Pressure:**  
Pmin= 0,2 kg/cm<sup>2</sup> (2,85PSI)  
Pmax= 6,0 kg/cm<sup>2</sup> (85,34 PSI)

### Despiece / Components

| Mod. | Descripción                                          | Mod. | Description                                  |
|------|------------------------------------------------------|------|----------------------------------------------|
| 1    | Rh-1395 Llave para Aireador                          | 1    | Rh-1395 Aerator Wrench                       |
| 2    | Rh-1393 Aireador para Salida                         | 2    | Rh-1393 Aerator                              |
| 3    | Rf-530 O'ring 2-116                                  | 3    | Rf-530 O'ring 2-116                          |
| 4    | Rh-1600 Rondana Antifricción E-300                   | 4    | Rh-1600 E-300 Antifricción Rubber Washer     |
| 5    | Rh-010 O'ring 2-111                                  | 5    | Rh-010 O'ring 2-111                          |
| 6    | Rh-127 O'ring 2-018                                  | 6    | Rh-127 O'ring 2-018                          |
| 7    | Rf-035 O'ring 2-123                                  | 7    | Rf-035 O'ring 2-123                          |
| 8    | Rh-759 Botón Latón Maneral                           | 8    | Rh-759 Handle Brass Button                   |
| 9    | Rh-002 O'ring 2-012                                  | 9    | Rh-002 O'ring 2-012                          |
| 10   | Rf-015 Tornillo 8-32 UNC-2A X 1/2"                   | 10   | Rf-015 8-32 UNC-2A X 1/2" Screw              |
| 11   | Rh-417 Maneral Albatros Izquierdo                    | 11   | Rh-417 Left Handle Albatros                  |
| 12   | Rh-464 Maneral Albatros Derecho                      | 12   | Rh-464 Right Handle Albatros                 |
| 13   | Rh-2471 Chapetón P/Contra tca. Valvex Mezc. Albatros | 13   | Rh-2471 Escutcheon for Mixing Valvex Locknut |
| 14   | Rr-291 O'ring 2-026                                  | 14   | Rr-291 O'ring 2-026                          |
| 15   | Rh-2469 Contra Tuerca para sujeción de Valvex        | 15   | Rh-2469 Clamping nut against Valvex          |
| 16   | Rh-703 O'ring 2-117                                  | 16   | Rh-703 O'ring 2-117                          |
| 17   | Sh-257 Valvex II Chico                               | 17   | Sh-257 Valvex II                             |
| 18   | Rh-2470 Chapetón p/ Mezcladora Fregadero HM,s        | 18   | Rh-2470 Mixer Sink Escutcheon                |
| 19   | Rh-1380 Rondana de Hule                              | 19   | Rh-1380 Rubber Washer                        |
| 20   | Rh-958 Cpo. Base Sal. 8" Fregadero                   | 20   | Rh-958 Output Base Body 8" Optima Sink       |
| 21   | Rh-2462 Empaque Base p/ Chapetón                     | 21   | Rh-2462 Base Gasket for Escutcheon           |
| 22   | Rh-1385 Empaque para Chapetón                        | 22   | Rh-1385 Gasket Escutcheon                    |
| 23   | Rh-117 Separador Cuerpo Central                      | 23   | Rh-117 Separator Body Central                |
| 24   | Rh-115 Tuerca Hexagonal p/Esparrago                  | 24   | Rh-115 Stud Hex Nut                          |
| 25   | Rh-1242 Llave Hexagonal 11/16"                       | 25   | Rh-1242 Hexagonal Wrench 11/16"              |
|      | Sub-ensamble                                         |      | Sub-assembly                                 |
| 26   | Sh-1192 Cuello de Ganso p/ Freg. 8" Arm.             | 26   | Sh-1192 Armed Rod for Sink                   |
| 27   | Sh-355 Kit de Botón Eur. c/ O'ring                   | 27   | Sh-355 Kit Boton Eur. c/O'ring               |

Hecho en México

\* Los productos ilustrados pueden sufrir cambios sin previo aviso en su aspecto o partes, como resultado de los procesos de mejora continua al que están sujetos, sin implicar mayor responsabilidad de la fábrica.



Made in México

\* Products shown may change without prior notice or parts in their appearance, as a result of continuous improvement processes that are subject, without involving greater responsibility of the factory.



